



**NEW**

pro clima

# CONTEGA<sup>®</sup> FIDEN EXO

Pre-compressed joint sealing tape for exterior use  
that is open to diffusion and resistant to driving rain

CONTEGA FIDEN EXO pre-compressed joint sealing tape for exterior applications can be used to create joints on building structures in a manner that is open to diffusion and resistant to driving rain. This particularly weather-resistant tape has a self-adhesive surface on one side for easy installation.

- ✓ Extremely weather-resistant
- ✓ BG1 quality
- ✓ Resistant to driving rain and open to diffusion
- ✓ RAL quality-tested installation
- ✓ Large range for all standard joint widths



[www.proclima.com.au](http://www.proclima.com.au)



# pro clima CONTEGA<sup>®</sup> FIDEN EXO

Pre-compressed joint sealing tape for exterior use that is open to diffusion and resistant to driving rain



## Technical data:

Substance	
Material	open-cell polyurethane flexible foam with polymer impregnation
Attribute	
Regulation	Value
Colour	anthracite
$s_p$ -value / g-value	< 0.5 m / < 2.5 MNs/g
Fire behaviour	DIN 4102 B1, P-NDS 04-218
Joint permeability	EN 1026 $a < 0.1 \text{ m}^3/[(\text{h}^* \text{m}^* (\text{daPa}) \text{n}]$
Loading group	DIN 18542 BG1
Resistance to driving rain	EN 1027 requirements fulfilled up to 600 Pa
Weather resistance	DIN 18542 passed
Can be plastered / painted over	yes
Compatibility with conventional construction materials	DIN 18542 yes
Application temperature	above +1 °C
Temperature resistance	permanent: -30 °C to +90 °C
Storage	1 °C - 20 °C, 12 months, cool and dry

## Forms of delivery:

Itemnumber	EAN	Roll width	Joint	Roll length	PU / box	Length / box	PU / pallet	Length / pallet
15547	4026639155474	10 mm	2-3 mm	10 m	30	300 m	60	18.00 m
15548	4026639155481	15 mm	2-3 mm	10 m	20	200 m	60	12.00 m
15549	4026639155498	12 mm	3-6 mm	8 m	25	240 m	60	14.40 m
15550	4026639155504	15 mm	3-6 mm	8 m	20	160 m	60	9.60 m
15552	4026639155528	15 mm	5-10 mm	5 m	20	112 m	60	6.72 m
15553	4026639155535	20 mm	5-10 mm	5 m	15	84 m	60	5.04 m
15554	4026639155542	15 mm	7-12 mm	4.3 m	20	86 m	60	5.16 m
15555	4026639155559	20 mm	7-12 mm	4.3 m	15	64.5 m	60	3.87 m
15556	4026639155566	20 mm	8-15 mm	3.3 m	15	49.5 m	60	2.97 m
15557	4026639155573	20 mm	10-18 mm	2.6 m	15	39 m	60	2.34 m

### Remove the protective sheet



1 Cut the outer protective sheet with a utility knife and remove this film.

### Cut off the start of the tape



2 Unroll some of the CONTEGA FIDEN EXO and cut off the overcompressed start of the tape (approx. 2 cm).

### Stick the tape to the frame



3 Remove the backing paper, align the tape straight on the frame and gradually stick in place. The tape must not be visible after installation (recess approx. 1 - 2 mm).

### Allow for slack in the tape

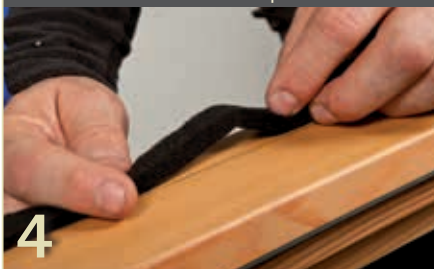

4 Allow for a small amount of slack in the tape when sticking it in place, particularly near joints – **do not stretch the tape!**

### Use butt-joints at corners



5 Stick the tape around the circumference of the frame. Use one length of CONTEGA FIDEN EXO per side here and use butt-joints at the corners. Allow for a small amount of slack near the corners.

### Install the window



6 Install the window professionally using a suitable fastening system.

Further information about application and construction is given in the pro clima planning documentation and application recommendations. (Please also note the recommendations of the currently valid version of the pro clima application matrix.)

Pro Clima Australia Pty Ltd  
 Freephone: 1800 PRO CLIMA (776 254)  
 Email: [welcome@proclima.com.au](mailto:welcome@proclima.com.au)

Passive House Pty Ltd  
 7-9 Raglan Street  
 North Melbourne  
 VIC 3051  
 Australia

☎ +61 (0) 3 9329 3693  
[contact@passivehouse.com.au](mailto:contact@passivehouse.com.au)

[www.passivehouse.com.au](http://www.passivehouse.com.au)

