

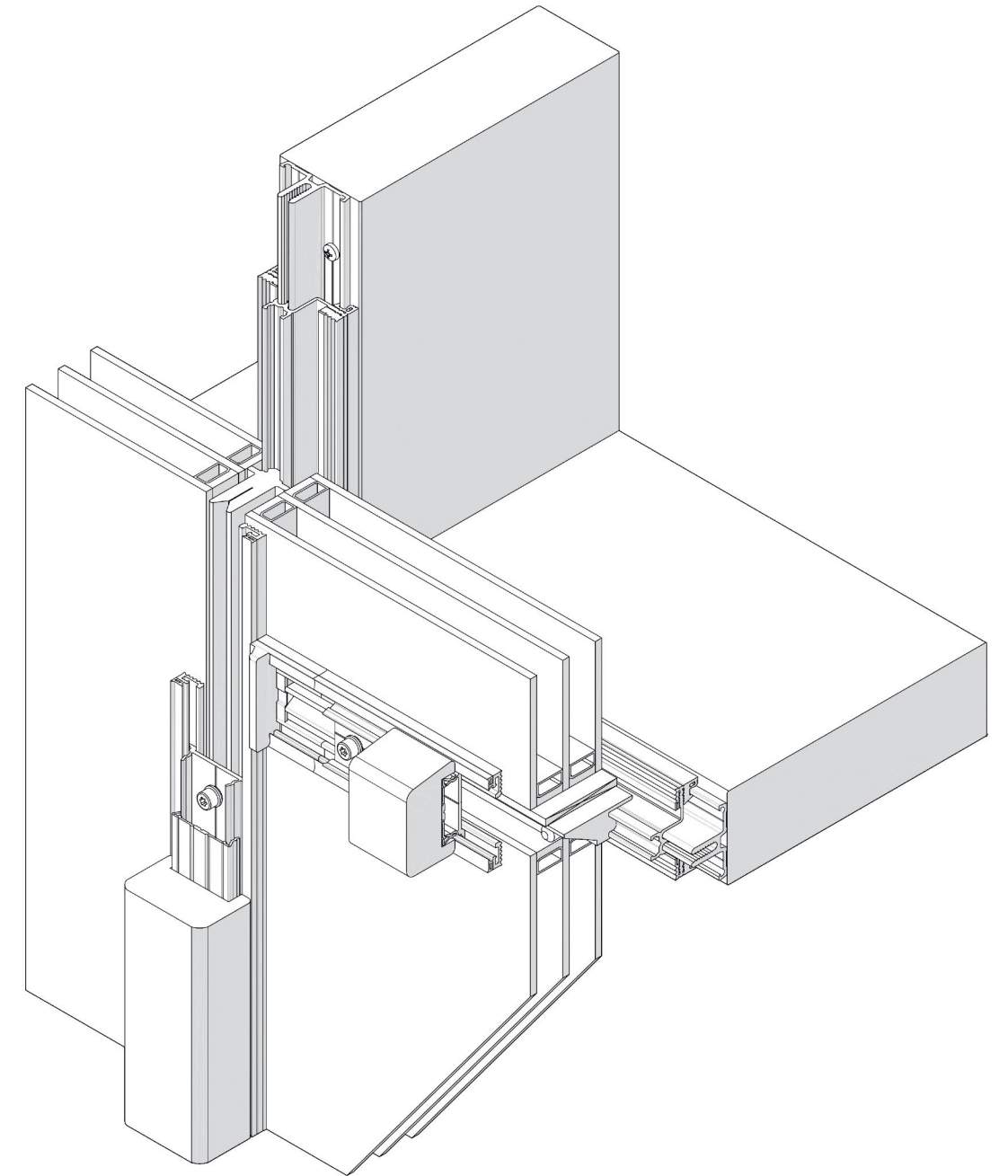

BAUTECHNIK





# PANORAMIC LIFT SLIDE



SCHEME A LEFT

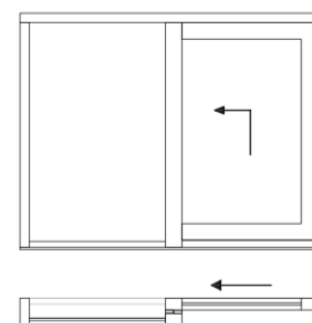

SCHEME A RIGHT

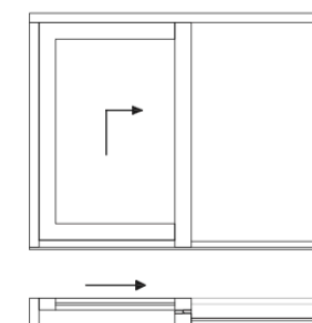

SCHEME G

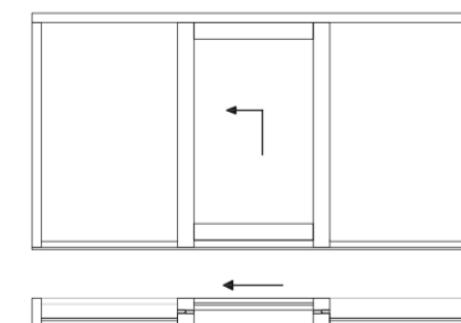

SCHEME A + 3 FIX

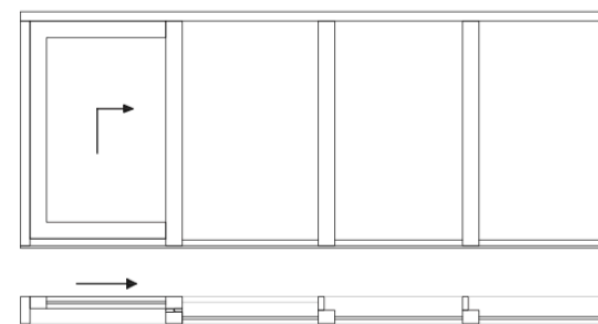

SCHEME A1 + 2 FIX

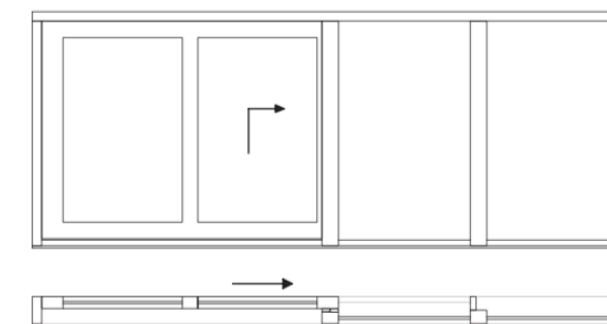

SCHEME K

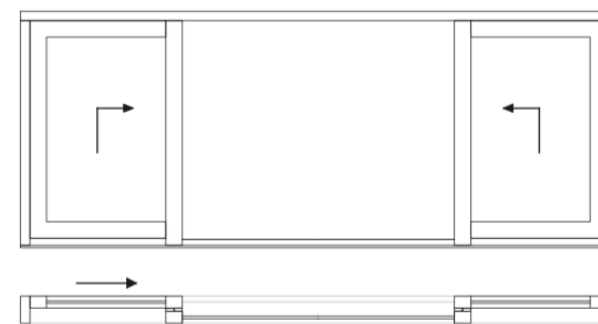

SCHEME C

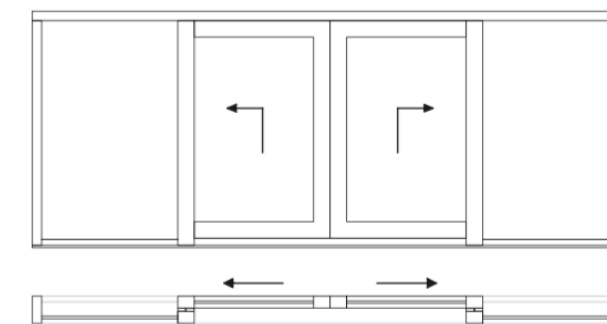

Made in Melbourne - by our team of trades, skilfully crafting at our workshop in Airport West, Victoria Australia





Architectural 'Passivhaus' timber curtain walls, and panoramic lift slide doors and windows, locally manufactured in Melbourne, Victoria in Australia by Passive House Pty Ltd.

Phone: 03 9329 3693

CAD and pdf's of our systems drawings are available by request: [info@passivehouse.com.au](mailto:info@passivehouse.com.au)

Visits to our workshop are also welcome, by appointment:

Rodd Rd,

Airport West VIC 3042

Phone: 03 9330 3003

[bautechnik.com.au](http://bautechnik.com.au)

[liftslide.com.au](http://liftslide.com.au)